

# Slika

---

**Bogdan, David**

**Supplement / Prilog**

*Publication year / Godina izdavanja:* **2016**

*Permanent link / Trajna poveznica:* <https://urn.nsk.hr/urn:nbn:hr:122:711374>

*Rights / Prava:* [In copyright](#)/[Zaštićeno autorskim pravom.](#)

*Download date / Datum preuzimanja:* **2024-06-16**



*Repository / Repozitorij:*

[University North Digital Repository](#)

1

2

3

4

A

B

C

D

E

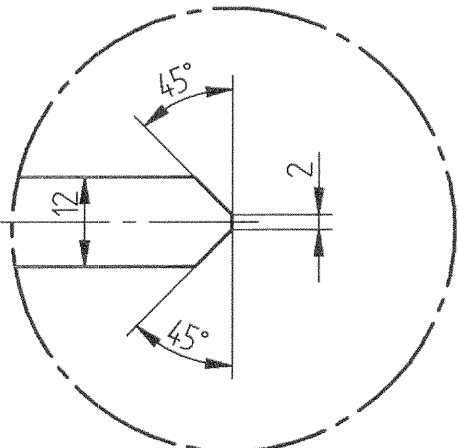
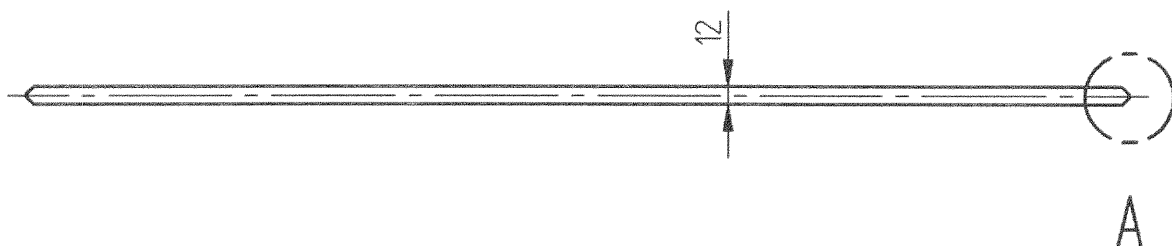
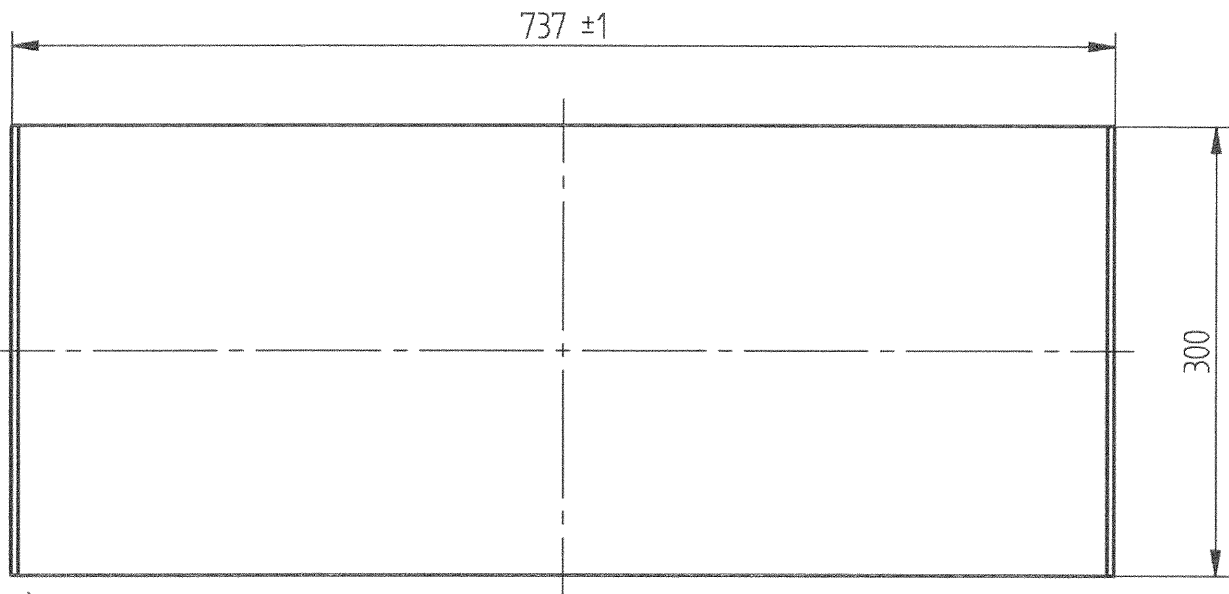

Allgemeintoleranzen  
siehe Werknorm 1.5  
General Tolerances  
WN-No.: 1.5

Sicherheitsteil / Safety Part

S1		S2		N	X
----	--	----	--	---	---

Ers. durch / REPL. BY:	Format / SIZE: A 4	Datum / DATE: 22.11.05	Name / NAME: J.Richter	Werkstoff / MATERIAL: S690QL
Ers. für / REPL. FOR:	Gezeichnet / DRAWN BY:	Geprüft / CHECKED BY:	Normgeprüft / APPROVED BY: 15.12.05	Werkst.Nr. / MATERIAL CODE: 18928
Ung.-Datum/EXPIRY DATE:	Schutzvermerk DIN 34-1-D Copyright reserved Schwing GmbH			Gewicht / WEIGHT (kg): 10,71
<b>Solid Edge - erstellt</b>				Maßstab / SCALE: 15
Benennung / NAME: Blech <i>Pos. 10</i>  plate <i>Rohrmast 6m</i>		Dokumentenfiosatz-Nr. / DIS NO: 1000049994		Material-Nr. / PART NO: 10217550
		Version	Datum / DATE	Name / NAME
DO NOT SCALE / Nicht abmessen				<b>SCHWING</b>